

Construction Practice of Urban and Rural Scenery Areas in Wenzhou

--Taking Yanzishan Park as an Example

Lei Tian

Wenzhou Polytechnic, Wenzhou, 325000, China.

895464301@qq.com

Abstract

With the proposal of the national "high-quality development" strategy, the Wenzhou Municipal Government has proposed a transformation plan to enhance the urban and rural landscape against this background. Wenzhou is a coastal area and an important "Maritime Silk Road" port. As an island tourism area, Dongtou District bears the image of Wenzhou as a "gateway". This article combines the characteristics of Yanzishan Park, collects data through on-site research and records, and takes the urban and rural landscape transformation plan of Wenzhou as an opportunity and guidance background to propose a conceptual design plan for Yanzishan Park. The plan proposes design ideas from four aspects: the integration and protection of existing resources, the manifestation and design of cultural landscapes, the bestowal of artistic landscapes, and the integration of diverse business forms, Thereby providing corresponding reference significance for future urban and rural style building.

Keywords

Urban and rural areas, High-quality development, Yanzishan Park, Cultural landscape.

1. Introduction

The proposed action plan for improving the urban and rural landscape of Wenzhou aims to address the issue of integrated urban and rural development. With the continuous expansion of cities and the increasing population in cities, rural culture has been severely damaged, coupled with a lack of awareness of the protection of traditional culture, and China's indigenous culture is increasingly melting. The upgrading and transformation of urban and rural areas is to integrate urban development with rural local culture, achieving a seamless connection between urban and rural areas, which not only protects traditional culture from destruction, but also brings urban development into a new business format. This is also an important reason for China to achieve the rural revitalization strategy.

2. Project status

Yanzishan Park is located in Dongtou District, Wenzhou. The northwest side of the project site is adjacent to the Gulf, the east side is an industrial park, and the south side is a residential area and passenger station. In the early stage, detailed research and literature inquiry were conducted on the project, and comprehensive research was conducted from different aspects such as roads, vegetation, culture, and history. The current problems include incomplete road systems, single and exposed vegetation, incomplete protection and design of cultural landscapes, and relatively independent parks. Aiming at the above problems and combining the

key points of the construction plan for the urban and rural landscape areas of Wenzhou, the overall plan design of Yanzishan Park is carried out.

3. Design scheme

3.1. Integration, protection and utilization of existing resources

The roads inside the park have problems such as missing, damaged, and different styles. After collecting and investigating on-site resources, the design proposal proposes to retain some of the road structures, and repair the missing or damaged roads in the later stage. The existing museums, island wharves, temple culture, etc. have undergone landscape improvement and subsequent renovation. The large area of green space on the west side of the site has been designed as the main entrance of the park, while other secondary entrances have been reserved and landscape improvement has been carried out, so that the entire entrance of the park can serve people in different areas. The existing infrastructure retains its original form in the design. In order to achieve the unified style of the entire park, a consistent design is considered for the later construction of the infrastructure. Yanzishan Park fully retains the most primitive resources and realizes the protection and development of landscape resources.

3.2. Presentation and Design of Cultural Landscape

According to the endowing and highlighting of culture, the conceptual plan proposes various cultural endowments based on solving the optimization of the ecological environment of human settlements. Combining the geographical advantages of Yanzishan Park and the historical development background of Wenzhou City, a health care greenway surrounding the mountains is set up. The greenway is divided into two parts. One part is to create a health care greenway with the theme of the Silk Road in combination with temple culture, The other part is located on the west side of the mountain and close to the coast. This area combines the island wharf to create a landscape trail of the Maritime Silk Road. The two parts of the trail revolve around the mountain. In terms of landscape and culture, elements are extracted from aspects such as the origin and history of the Silk Road to design a trail with diverse functions. A landscape avenue surrounding the mountain is set up on the hillside, and the cultural creation of the landscape also integrates the local culture of Yanzishan park. The historical legend of Yanzishan is personified and designed. The landscape avenue is provided with corresponding post stations and observation platforms at intervals. Each post station and platform is designed based on the intangible cultural heritage of Dongtou District: "Marine Animal Story", Thereby reflecting the integration of fun and culture (Figure 1). Through continuous integration and development, the integration of Yanzishan park's landscape and cultural atmosphere has been upgraded to a new level.

3.3. Endowment of artistic landscape

The creation of artistic landscapes is mainly aimed at fully catering to the aesthetic characteristics of urban populations. On the development path of urban-rural integration, the creation of Yanzishan should be designed in combination with the differences between urban and rural populations, in order to further achieve the optimal configuration of urban and rural landscape areas. The artistic landscape design of Yanzishan Park mainly combines the works of island art masters at home and abroad and other excellent cases to design, integrating the characteristic concepts of marine culture, and examining the landscape creation of the entire park from an artistic perspective. In the planning of the event, a marine art festival was added, and regular marine art exhibitions were held. Artists, scholars, and cultural and art enthusiasts from home and abroad were invited to visit the exhibition and create corresponding works. There is an existing seashell carving museum in Yanzishan, which mainly displays traditional seashell carving art techniques, which not only highlights the development of history, but also

further enhances the continuation of traditional Chinese culture and history. The cultural landscape of the entire Yanzishan Park is diverse and rich, thereby achieving the coordinated development of art and culture in the entire park space.

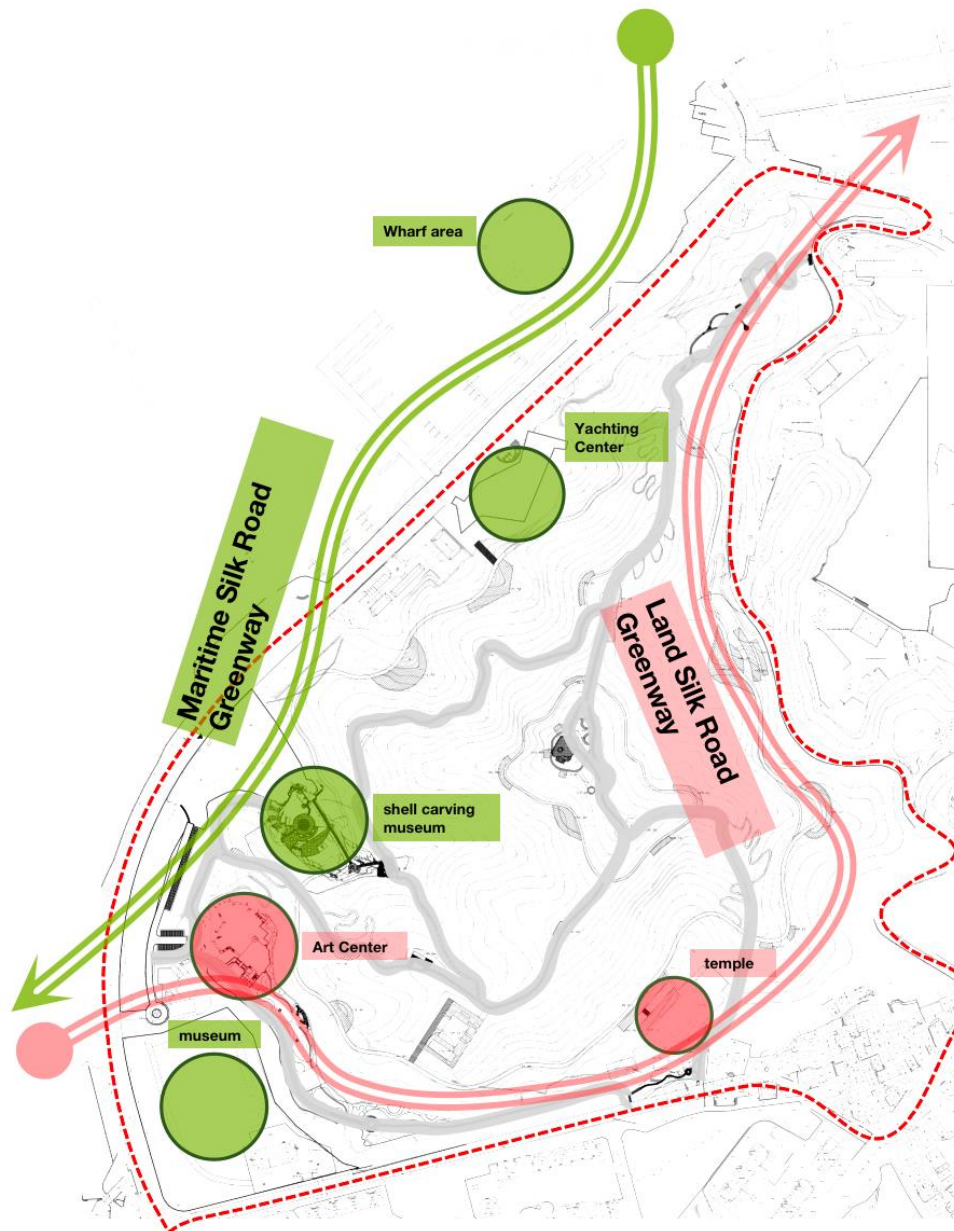

Figure 1. Planning Map of Silk Road Landscape Footpath in the Park

3.4. The integrated development of diverse business forms

The construction of urban and rural features in Wenzhou should highlight the characteristics of urban and rural areas. In the design of the plan, we also consider the diversified business forms around us to conduct research. Combining the characteristic island tourism construction ideas of Dongtou District with the existing resources of the surrounding areas, the first is to connect the roads in different regions, connect the roads around Yanzishan Park with important urban hubs, unify the main entrance and important transportation nodes of the park, and achieve the joint development of various regions; Then, carry out targeted design based on the advantages of each region, link the construction of tourism projects in different regions of Dongtou District, and achieve mutual communication and connection between various

important projects; Finally, the design of this region will achieve coordinated development. The surrounding area of Yanzishan Park should be comprehensively developed in combination with existing libraries, museums, art centers, dock cultural areas, and other aspects during construction to achieve the integration and diversified development of business formats.

4. Conclusion

The era is constantly developing, and the integrated and coordinated development of urban and rural areas is a product of the era and an inevitable trend of historical development. The development of Wenzhou has combined the high-quality development requirements of the country and proposed plans and actions to improve the urban and rural landscape areas. Based on the analysis of policies and the combing of relevant professional knowledge systems, this article focuses on the conceptual design scheme of Yanzishan Park to carry out the practice of the transformation and upgrading plan for urban and rural areas in Wenzhou, reflecting the research and application of relevant theoretical value, providing a certain theoretical basis and practical significance for the transformation of urban and rural areas in Wenzhou City and even the whole country. After studying the practice of Yanzishan Park and formulating the plan, the following conclusions have been reached:

First, respect local culture and the collection of existing resources. The protection of local culture is the primary condition. The protection of culture and the integration of existing resources in the early research of Yanzishan Park is the protection of local characteristic culture and resources.

Secondly, fully explore the creation of cultural landscapes. The plan for Yanzishan Park embodies the exploration of Wenzhou's urban history and culture, and combines the construction of a diverse cultural system to highlight the cultural continuity of the city. The design of Yanzishan Park is not only a perfect function, but also an important means of cultural output for a city.

Third, the fusion of artistic atmosphere. Art originates from life but is higher than life. In the development of modern society, art has begun to constantly appear in all aspects of life, and good art can output urban culture.

Fourth, enhance the diversification of business formats. The development of cities or rural areas is not based on individuals, and only through the integration of diversification and multipolarization can they flourish. Diversified business forms promote each other. With the improvement of people's living standards, people's spiritual ideology has undergone qualitative changes. Therefore, the design of Yanzishan Park will integrate art galleries, art centers, museums, yacht clubs, and other business forms to develop. This approach makes Yanzishan Park a complex integrating commerce, culture, and entertainment.

To sum up, the construction and promotion of modern urban and rural style areas should follow the protection of local culture and resources, explore culture and art, and supplement and enrich the business culture of the style areas, so that the construction of the style areas can have a driving force for sustainable development.

References

- [1] Balta S, Atik M. Rural planning guidelines for urban-rural transition zones as a tool for the protection of rural landscape characters and retaining urban sprawl: Antalya case from Mediterranean[J]. *Land Use Policy*, 2022, 119: 106144.
- [2] Qin Z, Ng S. Culture as inspiration: A metaphorical framework for designing products with traditional cultural properties (TCPs)[J]. *Sustainability*, 2020, 12(17): 7171.
- [3] Kruse J. *Seeing cities change: Local culture and class*[M]. Ashgate Publishing, Ltd., 2013.
- [4] *Andean Archaeology II: Art, Landscape, and Society*[M]. Springer, 2015.

- [5] Li Y, Hu Z. Approaching integrated urban-rural development in China: The changing institutional roles[J]. Sustainability, 2015, 7(6): 7031-7048.
- [6] Holloway Cripps K G. Art imitates life: art and architecture as a driving force for change[J]. Journal of Organizational Change Management, 2013, 26(1): 49-63.